

**Congestion Management Plan Update**  
Montgomery MPO

---

***PC-Travel Reports for study: SR-14 AM WB Study***

<u>Report Name</u>	<u>Page</u>
Study Summary .....	2
Overall Output Statistics .....	3
Detailed Statistics By Run - Travel Times .....	4
Detailed Statistics By Run - Average Speed .....	5
Detailed Statistics By Run - Total Delay .....	6
Detailed Statistics By Run - Time <= 0 MPH .....	7
Detailed Statistics By Run - Time <= 40 MPH .....	8
Detailed Statistics By Run - Time <= 55 MPH .....	9
Speed/Distance Profiles of All Runs .....	10

# Congestion Management Plan Update

Montgomery MPO

Study Name : **SR-14 AM WB Study**  
 Study Date : **11/14/2013**  
 Page No. : **2**

## Study Summary

### *Runs Used in This Study*

#### **Node Info**

#	Len	Name
1	0	N SR-143
2	747	Luckytown Rd
3	2423	Jackson St
4	2130	Cook Rd
5	4328	Airport Rd
6	1483	Friendly Pine Rd
7	3285	Bell Rd
8	371	Brownstone Loop
9	735	Brownstone Loop
10	459	Wood Gate Dr /
11	1335	Crossgate Dr
12	291	Pineleaf Rd
13	150	Unnamed Rd
14	683	Charleston Dr
15	720	Turtle Dr
16	465	Longview Rd
17	474	Ingram Rd
18	163	Pineleaf Rd
19	377	Sevarge Ln
20	627	Joseph Ct
21	1071	Unnamed Rd
22	1580	McKeithen Pl
23	1777	Deatsville Hwy / Main St
24	817	Dudley Dr
25	1017	Monument Dr
26	535	Knollwood Dr
27	2102	Old Prattville Rd
28	1507	Oak Tree Rd
29	3591	Dismukes Rd
30	179	Kensley Ln
31	1255	Summit Dr / CR-8
32	1647	Camp Grandview Rd
33	3326	I-65 N Ramps
34	383	I-65
35	354	I-65 S Ramps
36	607	Interstate Hwy Park
37	339	Interstate Hwy Park
38	582	Bus Park Dr

Run Title	Start Date	Start Time	Length	Before/ After	Run Type
SR-14 AM-WB-001 t	11/14/13	07:58	62751	Before	Secondary
SR-14 AM-WB-002 t	11/15/13	07:31	62836	Before	Secondary
SR-14 AM-WB-003 t	11/22/13	08:45	62766	Before	Secondary

**Notes:**

39	629	Malwest St
40	483	Old Farm Ln
41	923	Summit Pkwy
42	788	N Old Ridge Rd /
43	1605	Medical Center Dr
44	1525	Jasmine Trl
45	4019	Diane Dr
46	473	Chalet Woods Dr
47	630	Montview Ct
48	1106	Brookhaven Dr
49	329	Sycamore Dr
50	845	Edgewood Ave
51	1569	Walker St
52	303	Till Ct
53	343	Tew St
54	352	N Nichols St
55	325	Chester St
56	411	N Memorial Dr
57	439	Wright St
58	180	Wetumpka St
59	159	Gipson St
60	344	Gillespie St
61	322	Newton St
62	374	Gaddis Ave
63	331	Main St

Length of Study Route = 62,722 feet

# Congestion Management Plan Update

## Montgomery MPO

Study Name : SR-14 AM WB Study  
 Study Date : 11/14/2013  
 Page No. : 4

### Overall Output Statistics

Node #	Length	Node	Travel Time	# of Stops	Avg Speed	Total Delay	Time <= 0 MPH	Time <= 40 MPH	Time <= 55 MPH
1	0	N SR-143							
2	747	Luckytown Rd	14.3	0.0	35.5	5.0	0.0	10.0	14.3
3	2423	Jackson St	40.0	0.3	41.3	10.3	0.7	14.7	30.3
4	2130	Cook Rd	30.7	0.0	47.4	5.0	0.0	6.7	22.7
5	4328	Airport Rd	49.0	0.0	60.2	0.0	0.0	0.0	6.3
6	1483	Friendly Pine Rd	16.0	0.0	63.2	0.0	0.0	0.0	0.0
7	3285	Bell Rd	36.0	0.0	62.2	0.0	0.0	0.0	0.0
8	371	Brownstone Loop	4.0	0.0	63.2	0.0	0.0	0.0	0.0
9	735	Brownstone Loop	8.3	0.0	60.1	0.0	0.0	0.0	0.0
10	459	Wood Gate Dr / Governors	5.3	0.0	58.7	0.0	0.0	0.0	1.7
11	1335	Crossgate Dr	14.7	0.0	62.1	0.0	0.0	0.0	1.7
12	291	Pineleaf Rd	3.7	0.0	54.1	0.0	0.0	0.0	1.3
13	150	Unnamed Rd	2.0	0.0	51.1	0.0	0.0	0.0	0.3
14	683	Charleston Dr	8.0	0.0	58.2	0.0	0.0	0.0	2.7
15	720	Turtle Dr	8.0	0.0	61.4	0.0	0.0	0.0	0.0
16	465	Longview Rd	6.0	0.0	52.8	0.0	0.0	0.0	3.7
17	474	Ingram Rd	6.3	0.0	51.0	0.3	0.0	0.0	4.3
18	163	Pineleaf Rd	2.3	0.0	47.6	0.0	0.0	0.0	1.3
19	377	Sevarge Ln	5.0	0.0	51.4	0.3	0.0	0.0	5.0
20	627	Joseph Ct	8.3	0.0	51.3	0.3	0.0	0.0	8.0
21	1071	Unnamed Rd	14.7	0.0	49.8	1.0	0.0	0.0	14.7
22	1580	McKeithen Pl	23.3	0.0	46.2	3.3	0.0	1.3	21.3
23	1777	Deatsville Hwy / Main St	47.0	0.3	25.8	24.3	11.0	29.7	45.0
24	817	Dudley Dr	12.0	0.0	46.4	1.3	0.0	2.3	12.0
25	1017	Monument Dr	34.7	0.7	20.0	21.7	7.3	26.0	34.3
26	535	Knollwood Dr	9.3	0.0	39.1	2.3	0.0	5.3	8.7
27	2102	Old Prattville Rd	40.7	0.7	35.2	15.0	1.3	20.0	32.3
28	1507	Oak Tree Rd	21.0	0.0	48.9	2.7	0.0	4.7	11.3
29	3591	Dismukes Rd	41.7	0.0	58.8	0.0	0.0	0.0	8.3
30	179	Kensley Ln	2.0	0.0	61.0	0.0	0.0	0.0	0.0
31	1255	Summit Dr / CR-8	13.7	0.0	62.6	0.0	0.0	0.0	0.0
32	1647	Camp Grandview Rd	29.3	0.3	38.3	8.3	1.0	11.0	26.0
33	3326	I-65 N Ramps	61.7	0.3	36.8	19.7	4.3	21.7	57.3
34	383	I-65	6.0	0.0	43.5	1.0	0.0	3.0	6.0
35	354	I-65 S Ramps	5.3	0.0	45.3	0.7	0.0	0.0	5.3
36	607	Interstate Hwy Park Loop	8.7	0.0	47.8	0.7	0.0	0.0	8.3
37	339	Interstate Hwy Park Loop	4.7	0.0	49.5	0.3	0.0	0.3	4.7
38	582	Bus Park Dr	8.3	0.0	47.6	0.7	0.0	0.3	7.7
39	629	Malwest St	8.3	0.0	51.5	0.3	0.0	0.0	5.7

40	483	Old Farm Ln	6.3	0.0	52.0	0.3	0.0	0.0	4.7
41	923	Summit Pkwy	12.3	0.0	51.0	0.7	0.0	0.0	7.7
42	788	N Old Ridge Rd / McQueen	28.0	0.3	19.2	18.3	10.3	20.7	23.3
43	1605	Medical Center Dr	19.7	0.0	55.6	1.0	0.0	2.3	6.3
44	1525	Jasmine Trl	17.0	0.0	61.2	0.0	0.0	0.0	4.7
45	4019	Diane Dr	45.3	0.0	60.4	0.0	0.0	0.0	11.0
46	473	Chalet Woods Dr	6.0	0.0	53.8	0.0	0.0	0.0	4.3
47	630	Montview Ct	8.3	0.0	51.5	0.0	0.0	0.0	6.0
48	1106	Brookhaven Dr	15.7	0.0	48.1	0.0	0.0	0.0	11.0
49	329	Sycamore Dr	4.3	0.0	51.8	0.0	0.0	0.0	3.3
50	845	Edgewood Ave	12.0	0.0	48.0	0.0	0.0	0.0	11.3
51	1569	Walker St	24.0	0.0	44.6	0.0	0.0	2.7	24.0
52	303	Till Ct	5.0	0.0	41.3	0.7	0.0	2.3	5.0
53	343	Tew St	6.0	0.0	39.0	0.0	0.0	2.3	6.0
54	352	N Nichols St	8.7	0.0	27.7	2.7	0.0	6.0	8.7
55	325	Chester St	8.3	0.0	26.6	2.3	0.0	8.3	8.3
56	411	N Memorial Dr	27.3	0.7	10.3	20.3	7.0	27.3	27.3
57	439	Wright St	14.0	0.3	21.4	7.0	1.0	14.0	14.0
58	180	Wetumpka St	8.0	0.3	15.3	5.0	0.3	8.0	8.0
59	159	Gipson St	3.7	0.0	29.6	1.0	0.0	3.7	3.7
60	344	Gillespie St	7.3	0.0	32.0	1.3	0.0	7.3	7.3
61	322	Newton St	5.7	0.0	38.7	0.3	0.0	5.7	5.7
62	374	Gaddis Ave	7.3	0.0	34.8	1.3	0.0	7.3	7.3
63	331	Main St	41.0	0.7	5.5	36.0	23.0	41.0	41.0
<b>Total</b>	<b>62,722</b>		<b>1001.7</b>	<b>5.0</b>	<b>42.7</b>	<b>223.0</b>	<b>67.3</b>	<b>316.0</b>	<b>672.7</b>

Stats based on 3 BEFORE runs.  
Stops based on a Stop Speed of 5 MPH.

# Congestion Management Plan Update

## Montgomery MPO

Study Name : **SR-14 AM WB Study**  
 Study Date : **11/14/2013**  
 Page No. : **6**

### Detailed Statistics By Run

#### Travel Time (sec) by Section

*SR-14 AM-WB-001 t*  
*SR-14 AM-WB-002 t*  
*SR-14 AM-WB-003 t*

Node #	Length	Node Name	Run #1	Run #2	Run #3
1	0	N SR-143			
2	747	Luckytown Rd	14	15	14
3	2423	Jackson St	45	46	29
4	2130	Cook Rd	34	34	24
5	4328	Airport Rd	51	51	45
6	1483	Friendly Pine Rd	16	16	16
7	3285	Bell Rd	37	36	35
8	371	Brownstone Loop	4	4	4
9	735	Brownstone Loop	9	8	8
10	459	Wood Gate Dr /	6	5	5
11	1335	Crossgate Dr	15	15	14
12	291	Pineleaf Rd	4	4	3
13	150	Unnamed Rd	2	2	2
14	683	Charleston Dr	8	9	7
15	720	Turtle Dr	8	8	8
16	465	Longview Rd	6	6	6
17	474	Ingram Rd	6	6	7
18	163	Pineleaf Rd	2	3	2
19	377	Sevarge Ln	5	4	6
20	627	Joseph Ct	7	9	9
21	1071	Unnamed Rd	14	14	16
22	1580	McKeithen Pl	22	25	23
23	1777	Deatsville Hwy / Main St	23	94	24
24	817	Dudley Dr	10	15	11
25	1017	Monument Dr	31	60	13
26	535	Knollwood Dr	10	11	7
27	2102	Old Prattville Rd	42	55	25
28	1507	Oak Tree Rd	21	25	17
29	3591	Dismukes Rd	39	41	45
30	179	Kensley Ln	2	2	2
31	1255	Summit Dr / CR-8	14	14	13
32	1647	Camp Grandview Rd	21	44	23
33	3326	I-65 N Ramps	43	53	89
34	383	I-65	5	6	7

35	354	I-65 S Ramps	4	6	6
36	607	Interstate Hwy Park Loop	9	9	8
37	339	Interstate Hwy Park Loop	5	5	4
38	582	Bus Park Dr	9	9	7
39	629	Malwest St	8	9	8
40	483	Old Farm Ln	6	7	6
41	923	Summit Pkwy	12	14	11
42	788	N Old Ridge Rd /	10	65	9
43	1605	Medical Center Dr	18	24	17
44	1525	Jasmine Trl	19	17	15
45	4019	Diane Dr	50	44	42
46	473	Chalet Woods Dr	7	6	5
47	630	Montview Ct	9	9	7
48	1106	Brookhaven Dr	17	16	14
49	329	Sycamore Dr	4	5	4
50	845	Edgewood Ave	13	12	11
51	1569	Walker St	26	24	22
52	303	Till Ct	7	4	4
53	343	Tew St	7	6	5
54	352	N Nichols St	6	14	6
55	325	Chester St	7	12	6
56	411	N Memorial Dr	22	45	15
57	439	Wright St	11	20	11
58	180	Wetumpka St	4	7	13
59	159	Gipson St	3	4	4
60	344	Gillespie St	6	8	8
61	322	Newton St	5	6	6
62	374	Gaddis Ave	8	8	6
63	331	Main St	15	7	101
<b>Totals</b>	<b>62722</b>		<b>903</b>	<b>1,162</b>	<b>940</b>

# Congestion Management Plan Update

## Montgomery MPO

Study Name : **SR-14 AM WB Study**  
 Study Date : **11/14/2013**  
 Page No. : **8**

### Detailed Statistics By Run

#### Average Speed (MPH) by Section

SR-14 AM-WB-001 t  
 SR-14 AM-WB-002 t  
 SR-14 AM-WB-003 t

Node #	Length	Node Name	Run #1	Run #2	Run #3
1	0	N SR-143			
2	747	Luckytown Rd	36.8	34.3	38.3
3	2423	Jackson St	36.7	36.0	57.8
4	2130	Cook Rd	42.5	43.2	61.0
5	4328	Airport Rd	58.9	58.1	64.3
6	1483	Friendly Pine Rd	61.3	62.1	65.2
7	3285	Bell Rd	60.7	62.3	63.6
8	371	Brownstone Loop	57.3	63.0	64.0
9	735	Brownstone Loop	58.7	63.0	63.4
10	459	Wood Gate Dr /	55.0	63.0	63.0
11	1335	Crossgate Dr	58.4	58.4	63.3
12	291	Pineleaf Rd	55.0	52.0	64.0
13	150	Unnamed Rd	56.0	55.0	63.5
14	683	Charleston Dr	57.5	54.2	63.6
15	720	Turtle Dr	57.3	56.6	60.1
16	465	Longview Rd	55.2	53.3	52.2
17	474	Ingram Rd	56.0	53.2	47.4
18	163	Pineleaf Rd	55.5	55.0	46.0
19	377	Sevarge Ln	53.6	53.0	45.3
20	627	Joseph Ct	54.6	51.7	47.0
21	1071	Unnamed Rd	51.9	49.6	45.6
22	1580	McKeithen Pl	51.0	42.9	46.4
23	1777	Deatsville Hwy / Main St	52.2	12.9	51.3
24	817	Dudley Dr	53.0	39.7	50.2
25	1017	Monument Dr	22.5	11.1	52.3
26	535	Knollwood Dr	39.7	33.1	54.4
27	2102	Old Prattville Rd	33.1	26.0	58.5
28	1507	Oak Tree Rd	50.3	41.7	60.2
29	3591	Dismukes Rd	62.9	60.2	54.1
30	179	Kensley Ln	63.0	61.0	65.0
31	1255	Summit Dr / CR-8	63.0	60.4	65.0
32	1647	Camp Grandview Rd	50.8	25.6	48.7
33	3326	I-65 N Ramps	53.4	42.7	25.5
34	383	I-65	53.4	40.5	36.0



35	354	I-65 S Ramps	52.3	43.3	43.5
36	607	Interstate Hwy Park Loop	49.6	45.3	52.3
37	339	Interstate Hwy Park Loop	41.2	45.2	52.0
38	582	Bus Park Dr	45.0	46.7	53.7
39	629	Malwest St	52.5	46.6	57.4
40	483	Old Farm Ln	52.2	46.3	55.7
41	923	Summit Pkwy	53.8	46.4	56.9
42	788	N Old Ridge Rd /	55.3	7.8	62.1
43	1605	Medical Center Dr	61.7	47.0	65.0
44	1525	Jasmine Trl	52.4	62.3	65.5
45	4019	Diane Dr	54.7	61.8	66.0
46	473	Chalet Woods Dr	48.4	50.0	61.0
47	630	Montview Ct	46.7	48.8	58.7
48	1106	Brookhaven Dr	46.1	47.2	55.7
49	329	Sycamore Dr	47.5	45.4	55.5
50	845	Edgewood Ave	46.3	46.3	51.7
51	1569	Walker St	40.3	45.5	48.3
52	303	Till Ct	27.7	44.5	50.0
53	343	Tew St	38.3	40.8	48.2
54	352	N Nichols St	39.2	16.8	42.7
55	325	Chester St	28.4	18.9	36.7
56	411	N Memorial Dr	13.2	6.5	18.2
57	439	Wright St	27.4	14.0	26.0
58	180	Wetumpka St	32.8	18.6	9.4
59	159	Gipson St	35.7	25.8	27.0
60	344	Gillespie St	39.0	32.3	32.3
61	322	Newton St	39.0	34.2	37.7
62	374	Gaddis Ave	35.0	31.9	37.0
63	331	Main St	14.7	32.6	2.4
<b>Totals</b>	<b>62722</b>		<b>47.4</b>	<b>36.8</b>	<b>45.5</b>

# Congestion Management Plan Update

## Montgomery MPO

Study Name : **SR-14 AM WB Study**  
 Study Date : **11/14/2013**  
 Page No. : **10**

### Detailed Statistics By Run

#### Total Delay (sec) by Section

SR-14 AM-WB-001 t  
 SR-14 AM-WB-002 t  
 SR-14 AM-WB-003 t

Node #	Length	Node Name	Run #1	Run #2	Run #3
1	0	N SR-143			
2	747	Luckytown Rd	5	6	4
3	2423	Jackson St	15	16	0
4	2130	Cook Rd	8	7	0
5	4328	Airport Rd	0	0	0
6	1483	Friendly Pine Rd	0	0	0
7	3285	Bell Rd	0	0	0
8	371	Brownstone Loop	0	0	0
9	735	Brownstone Loop	0	0	0
10	459	Wood Gate Dr /	0	0	0
11	1335	Crossgate Dr	0	0	0
12	291	Pineleaf Rd	0	0	0
13	150	Unnamed Rd	0	0	0
14	683	Charleston Dr	0	0	0
15	720	Turtle Dr	0	0	0
16	465	Longview Rd	0	0	0
17	474	Ingram Rd	0	0	1
18	163	Pineleaf Rd	0	0	0
19	377	Sevarge Ln	0	0	1
20	627	Joseph Ct	0	0	1
21	1071	Unnamed Rd	1	0	2
22	1580	McKeithen Pl	2	5	3
23	1777	Deatsville Hwy / Main St	0	72	1
24	817	Dudley Dr	0	4	0
25	1017	Monument Dr	18	47	0
26	535	Knollwood Dr	3	4	0
27	2102	Old Prattville Rd	16	29	0
28	1507	Oak Tree Rd	2	6	0
29	3591	Dismukes Rd	0	0	0
30	179	Kensley Ln	0	0	0
31	1255	Summit Dr / CR-8	0	0	0
32	1647	Camp Grandview Rd	0	23	2
33	3326	I-65 N Ramps	1	11	47
34	383	I-65	0	1	2

35	354	I-65 S Ramps	0	1	1
36	607	Interstate Hwy Park Loop	1	1	0
37	339	Interstate Hwy Park Loop	0	1	0
38	582	Bus Park Dr	1	1	0
39	629	Malwest St	0	1	0
40	483	Old Farm Ln	0	1	0
41	923	Summit Pkwy	0	2	0
42	788	N Old Ridge Rd /	0	55	0
43	1605	Medical Center Dr	0	3	0
44	1525	Jasmine Trl	0	0	0
45	4019	Diane Dr	0	0	0
46	473	Chalet Woods Dr	0	0	0
47	630	Montview Ct	0	0	0
48	1106	Brookhaven Dr	0	0	0
49	329	Sycamore Dr	0	0	0
50	845	Edgewood Ave	0	0	0
51	1569	Walker St	0	0	0
52	303	Till Ct	2	0	0
53	343	Tew St	0	0	0
54	352	N Nichols St	0	8	0
55	325	Chester St	1	6	0
56	411	N Memorial Dr	15	38	8
57	439	Wright St	4	13	4
58	180	Wetumpka St	1	4	10
59	159	Gipson St	0	2	1
60	344	Gillespie St	0	2	2
61	322	Newton St	0	1	0
62	374	Gaddis Ave	2	2	0
63	331	Main St	10	2	96
<b>Totals</b>	<b>62722</b>		<b>108</b>	<b>375</b>	<b>186</b>

# Congestion Management Plan Update

## Montgomery MPO

Study Name : **SR-14 AM WB Study**  
 Study Date : **11/14/2013**  
 Page No. : **12**

### Detailed Statistics By Run

#### Time <= 0 MPH by Section

SR-14 AM-WB-001 t  
 SR-14 AM-WB-002 t  
 SR-14 AM-WB-003 t

Node #	Length	Node Name	Run #1	Run #2	Run #3
1	0	N SR-143			
2	747	Luckytown Rd	0	0	0
3	2423	Jackson St	2	0	0
4	2130	Cook Rd	0	0	0
5	4328	Airport Rd	0	0	0
6	1483	Friendly Pine Rd	0	0	0
7	3285	Bell Rd	0	0	0
8	371	Brownstone Loop	0	0	0
9	735	Brownstone Loop	0	0	0
10	459	Wood Gate Dr /	0	0	0
11	1335	Crossgate Dr	0	0	0
12	291	Pineleaf Rd	0	0	0
13	150	Unnamed Rd	0	0	0
14	683	Charleston Dr	0	0	0
15	720	Turtle Dr	0	0	0
16	465	Longview Rd	0	0	0
17	474	Ingram Rd	0	0	0
18	163	Pineleaf Rd	0	0	0
19	377	Sevarge Ln	0	0	0
20	627	Joseph Ct	0	0	0
21	1071	Unnamed Rd	0	0	0
22	1580	McKeithen Pl	0	0	0
23	1777	Deatsville Hwy / Main St	0	33	0
24	817	Dudley Dr	0	0	0
25	1017	Monument Dr	1	21	0
26	535	Knollwood Dr	0	0	0
27	2102	Old Prattville Rd	2	2	0
28	1507	Oak Tree Rd	0	0	0
29	3591	Dismukes Rd	0	0	0
30	179	Kensley Ln	0	0	0
31	1255	Summit Dr / CR-8	0	0	0
32	1647	Camp Grandview Rd	0	3	0
33	3326	I-65 N Ramps	0	0	13
34	383	I-65	0	0	0

35	354	I-65 S Ramps	0	0	0
36	607	Interstate Hwy Park Loop	0	0	0
37	339	Interstate Hwy Park Loop	0	0	0
38	582	Bus Park Dr	0	0	0
39	629	Malwest St	0	0	0
40	483	Old Farm Ln	0	0	0
41	923	Summit Pkwy	0	0	0
42	788	N Old Ridge Rd /	0	31	0
43	1605	Medical Center Dr	0	0	0
44	1525	Jasmine Trl	0	0	0
45	4019	Diane Dr	0	0	0
46	473	Chalet Woods Dr	0	0	0
47	630	Montview Ct	0	0	0
48	1106	Brookhaven Dr	0	0	0
49	329	Sycamore Dr	0	0	0
50	845	Edgewood Ave	0	0	0
51	1569	Walker St	0	0	0
52	303	Till Ct	0	0	0
53	343	Tew St	0	0	0
54	352	N Nichols St	0	0	0
55	325	Chester St	0	0	0
56	411	N Memorial Dr	2	19	0
57	439	Wright St	0	3	0
58	180	Wetumpka St	0	0	1
59	159	Gipson St	0	0	0
60	344	Gillespie St	0	0	0
61	322	Newton St	0	0	0
62	374	Gaddis Ave	0	0	0
63	331	Main St	0	0	69
<b>Totals</b>	<b>62722</b>		<b>7</b>	<b>112</b>	<b>83</b>

# Congestion Management Plan Update

## Montgomery MPO

Study Name : **SR-14 AM WB Study**  
 Study Date : **11/14/2013**  
 Page No. : **14**

### Detailed Statistics By Run

#### Time <= 40 MPH by Section

SR-14 AM-WB-001 t  
 SR-14 AM-WB-002 t  
 SR-14 AM-WB-003 t

Node #	Length	Node Name	Run #1	Run #2	Run #3
1	0	N SR-143			
2	747	Luckytown Rd	9	14	7
3	2423	Jackson St	17	27	0
4	2130	Cook Rd	10	10	0
5	4328	Airport Rd	0	0	0
6	1483	Friendly Pine Rd	0	0	0
7	3285	Bell Rd	0	0	0
8	371	Brownstone Loop	0	0	0
9	735	Brownstone Loop	0	0	0
10	459	Wood Gate Dr /	0	0	0
11	1335	Crossgate Dr	0	0	0
12	291	Pineleaf Rd	0	0	0
13	150	Unnamed Rd	0	0	0
14	683	Charleston Dr	0	0	0
15	720	Turtle Dr	0	0	0
16	465	Longview Rd	0	0	0
17	474	Ingram Rd	0	0	0
18	163	Pineleaf Rd	0	0	0
19	377	Sevarge Ln	0	0	0
20	627	Joseph Ct	0	0	0
21	1071	Unnamed Rd	0	0	0
22	1580	McKeithen Pl	0	4	0
23	1777	Deatsville Hwy / Main St	0	89	0
24	817	Dudley Dr	0	7	0
25	1017	Monument Dr	22	56	0
26	535	Knollwood Dr	5	11	0
27	2102	Old Prattville Rd	18	42	0
28	1507	Oak Tree Rd	4	10	0
29	3591	Dismukes Rd	0	0	0
30	179	Kensley Ln	0	0	0
31	1255	Summit Dr / CR-8	0	0	0
32	1647	Camp Grandview Rd	0	29	4
33	3326	I-65 N Ramps	0	10	55
34	383	I-65	0	2	7

35	354	I-65 S Ramps	0	0	0
36	607	Interstate Hwy Park Loop	0	0	0
37	339	Interstate Hwy Park Loop	1	0	0
38	582	Bus Park Dr	1	0	0
39	629	Malwest St	0	0	0
40	483	Old Farm Ln	0	0	0
41	923	Summit Pkwy	0	0	0
42	788	N Old Ridge Rd /	0	62	0
43	1605	Medical Center Dr	0	7	0
44	1525	Jasmine Trl	0	0	0
45	4019	Diane Dr	0	0	0
46	473	Chalet Woods Dr	0	0	0
47	630	Montview Ct	0	0	0
48	1106	Brookhaven Dr	0	0	0
49	329	Sycamore Dr	0	0	0
50	845	Edgewood Ave	0	0	0
51	1569	Walker St	8	0	0
52	303	Till Ct	7	0	0
53	343	Tew St	5	2	0
54	352	N Nichols St	3	14	1
55	325	Chester St	7	12	6
56	411	N Memorial Dr	22	45	15
57	439	Wright St	11	20	11
58	180	Wetumpka St	4	7	13
59	159	Gipson St	3	4	4
60	344	Gillespie St	6	8	8
61	322	Newton St	5	6	6
62	374	Gaddis Ave	8	8	6
63	331	Main St	15	7	101
<b>Totals</b>	<b>62722</b>		<b>191</b>	<b>513</b>	<b>244</b>

# Congestion Management Plan Update

## Montgomery MPO

Study Name : **SR-14 AM WB Study**  
 Study Date : **11/14/2013**  
 Page No. : **16**

### Detailed Statistics By Run

#### Time <= 55 MPH by Section

*SR-14 AM-WB-001 t*  
*SR-14 AM-WB-002 t*  
*SR-14 AM-WB-003 t*

Node #	Length	Node Name	Run #1	Run #2	Run #3
1	0	N SR-143			
2	747	Luckytown Rd	14	15	14
3	2423	Jackson St	45	46	0
4	2130	Cook Rd	34	34	0
5	4328	Airport Rd	8	11	0
6	1483	Friendly Pine Rd	0	0	0
7	3285	Bell Rd	0	0	0
8	371	Brownstone Loop	0	0	0
9	735	Brownstone Loop	0	0	0
10	459	Wood Gate Dr /	5	0	0
11	1335	Crossgate Dr	0	5	0
12	291	Pineleaf Rd	0	4	0
13	150	Unnamed Rd	0	1	0
14	683	Charleston Dr	0	8	0
15	720	Turtle Dr	0	0	0
16	465	Longview Rd	1	5	5
17	474	Ingram Rd	0	6	7
18	163	Pineleaf Rd	0	2	2
19	377	Sevarge Ln	5	4	6
20	627	Joseph Ct	6	9	9
21	1071	Unnamed Rd	14	14	16
22	1580	McKeithen Pl	16	25	23
23	1777	Deatsville Hwy / Main St	17	94	24
24	817	Dudley Dr	10	15	11
25	1017	Monument Dr	31	60	12
26	535	Knollwood Dr	10	11	5
27	2102	Old Prattville Rd	42	55	0
28	1507	Oak Tree Rd	11	23	0
29	3591	Dismukes Rd	0	0	25
30	179	Kensley Ln	0	0	0
31	1255	Summit Dr / CR-8	0	0	0
32	1647	Camp Grandview Rd	17	44	17
33	3326	I-65 N Ramps	30	53	89
34	383	I-65	5	6	7



35	354	I-65 S Ramps	4	6	6
36	607	Interstate Hwy Park Loop	9	9	7
37	339	Interstate Hwy Park Loop	5	5	4
38	582	Bus Park Dr	9	9	5
39	629	Malwest St	8	9	0
40	483	Old Farm Ln	6	7	1
41	923	Summit Pkwy	9	14	0
42	788	N Old Ridge Rd /	5	65	0
43	1605	Medical Center Dr	0	19	0
44	1525	Jasmine Trl	14	0	0
45	4019	Diane Dr	24	9	0
46	473	Chalet Woods Dr	7	6	0
47	630	Montview Ct	9	9	0
48	1106	Brookhaven Dr	17	16	0
49	329	Sycamore Dr	4	5	1
50	845	Edgewood Ave	13	12	9
51	1569	Walker St	26	24	22
52	303	Till Ct	7	4	4
53	343	Tew St	7	6	5
54	352	N Nichols St	6	14	6
55	325	Chester St	7	12	6
56	411	N Memorial Dr	22	45	15
57	439	Wright St	11	20	11
58	180	Wetumpka St	4	7	13
59	159	Gipson St	3	4	4
60	344	Gillespie St	6	8	8
61	322	Newton St	5	6	6
62	374	Gaddis Ave	8	8	6
63	331	Main St	15	7	101
<b>Totals</b>	<b>62722</b>		<b>591</b>	<b>915</b>	<b>512</b>

# Congestion Management Plan Update

## Montgomery MPO

Study Name : SR-14 AM WB Study  
 Study Date : 11/14/2013  
 Page No. : 18

### Speed/Distance Profiles of All Runs

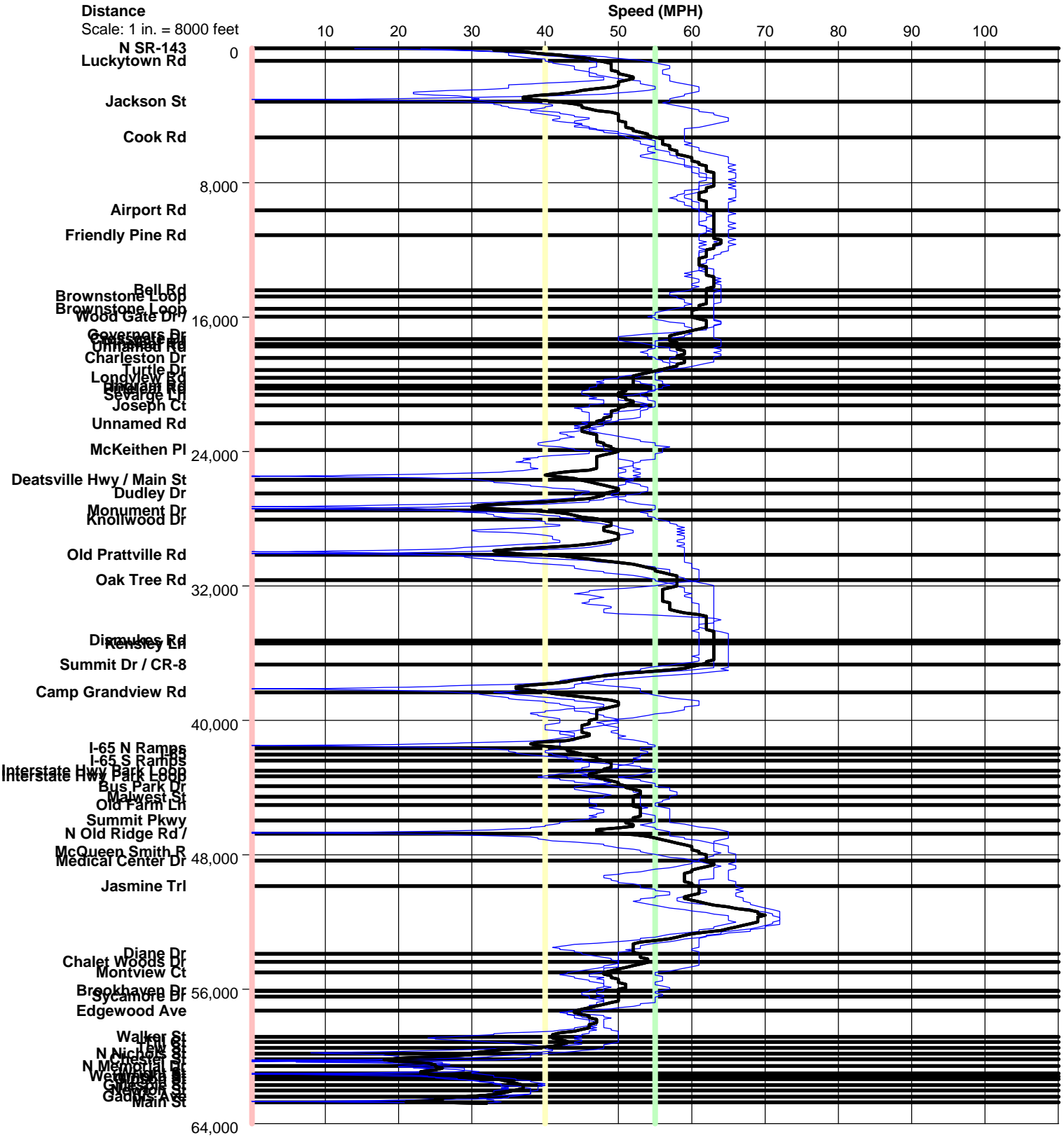

SR-14 AM WB

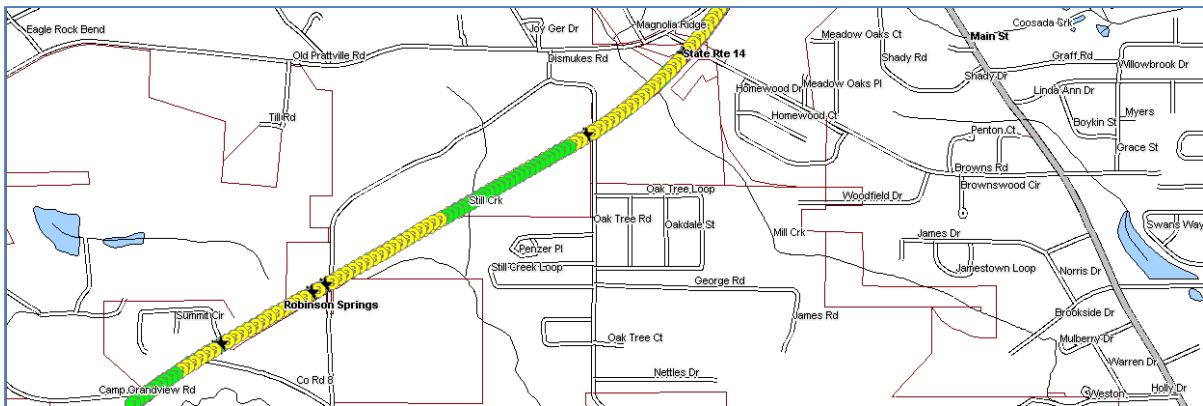
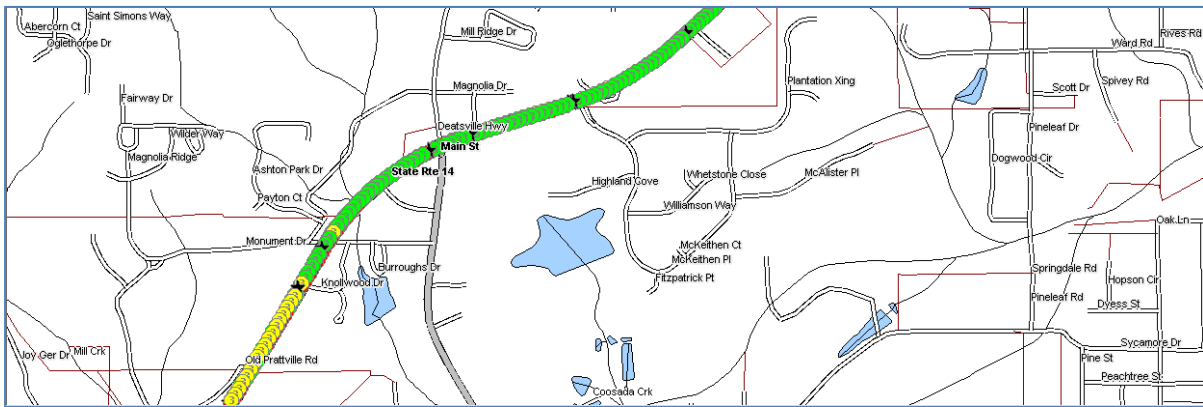
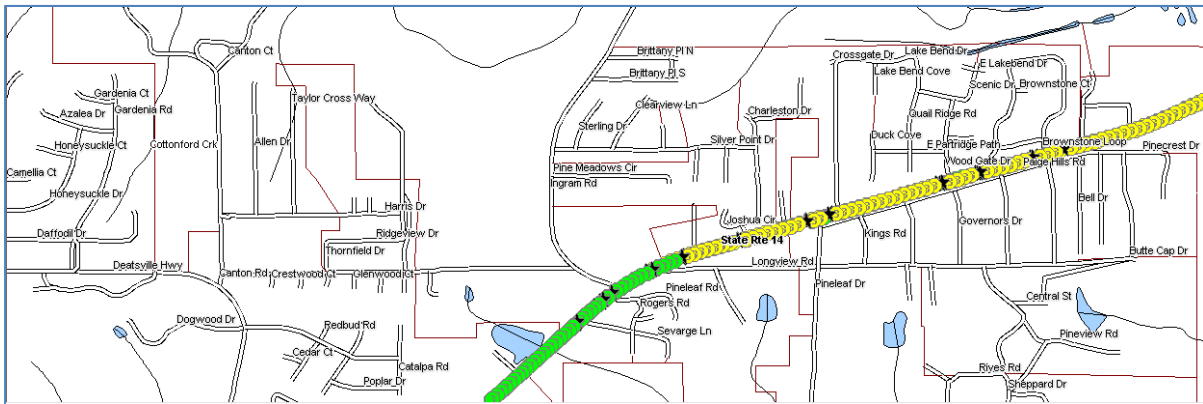
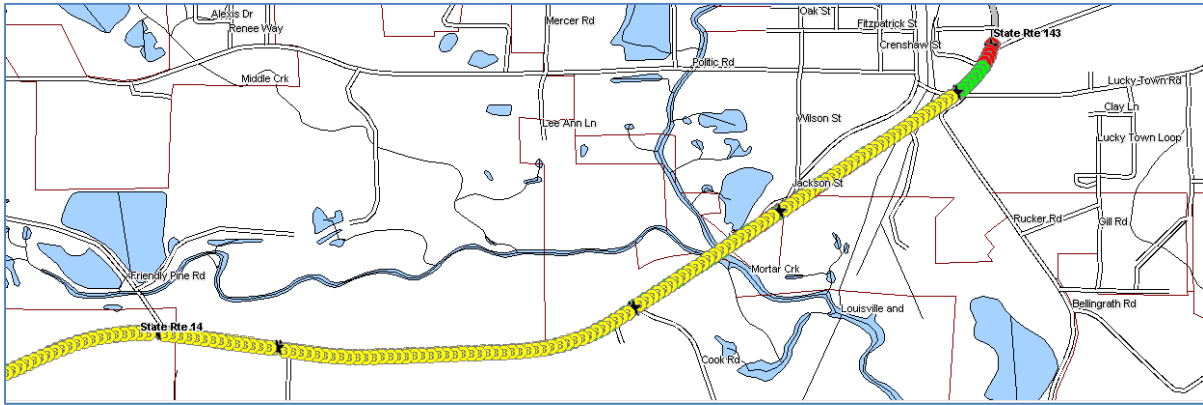

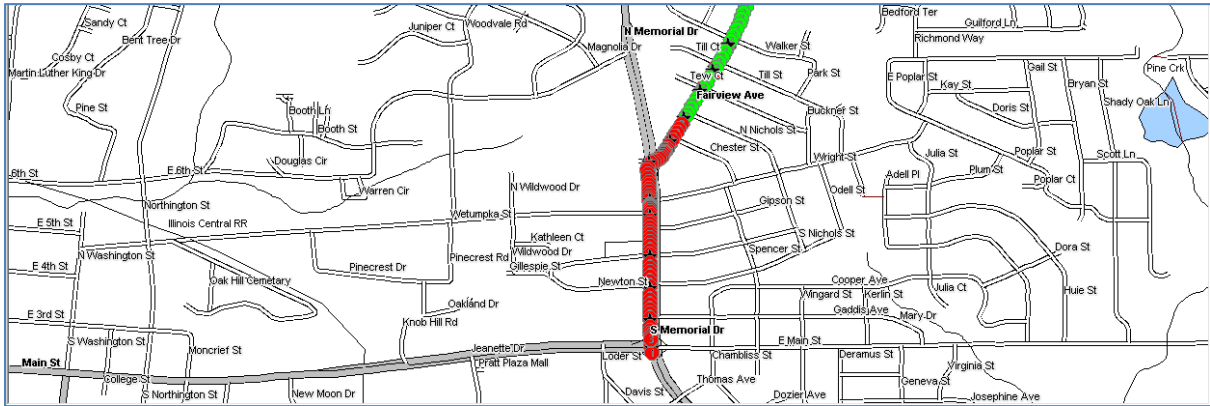
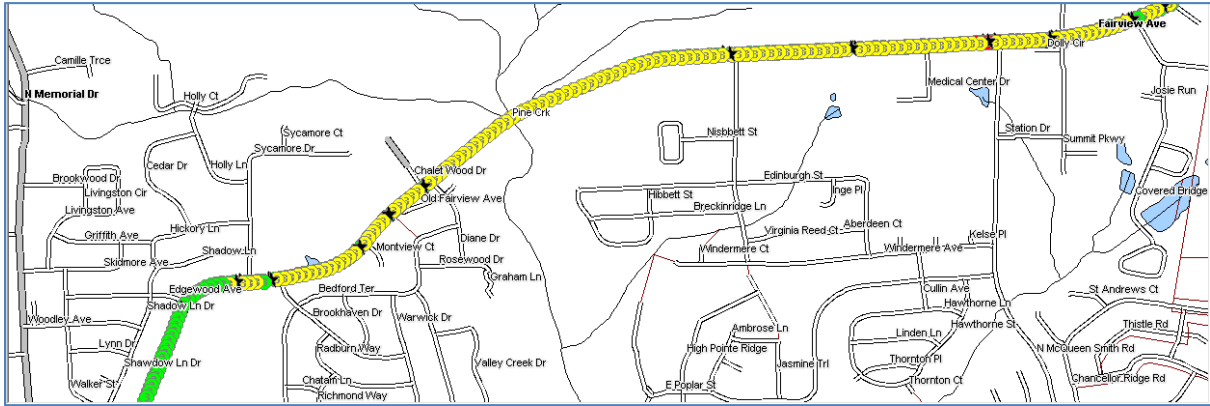
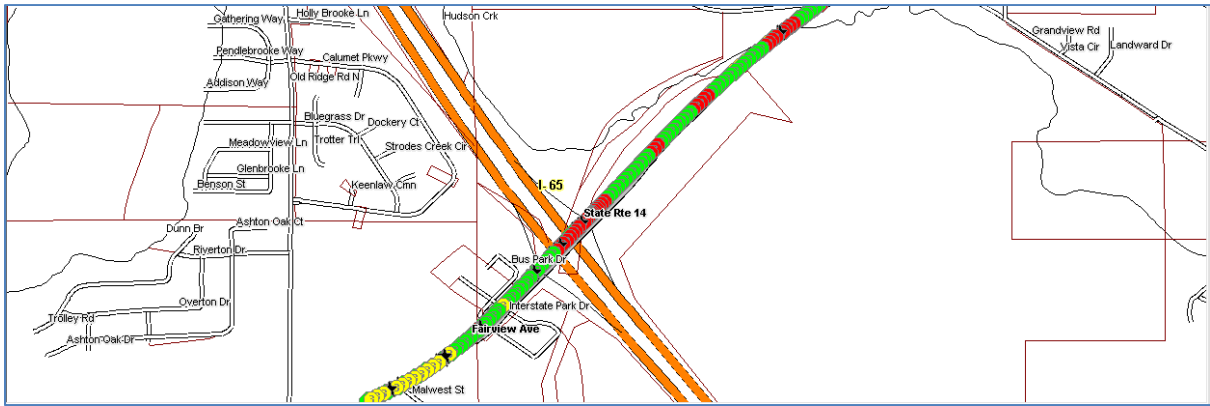

Color Code Speeds

Speed 1	0	To	40
Speed 2	40	To	55
Speed 3	55	To	99